



# 2021 Home·A·Rama Aberdeen



Gollner Homes provides excellence in customer relations, project management and craftsmanship. For over 55 years, the Gollner family has been building and remodeling homes and businesses. As a premiere builder in Central Indiana we look forward to bringing our product and service to the extraordinary landscape of Aberdeen.



  
**GOLLNER**  
HOMES

BUILDING.  
FOR GENERATIONS.

# Floor Plans

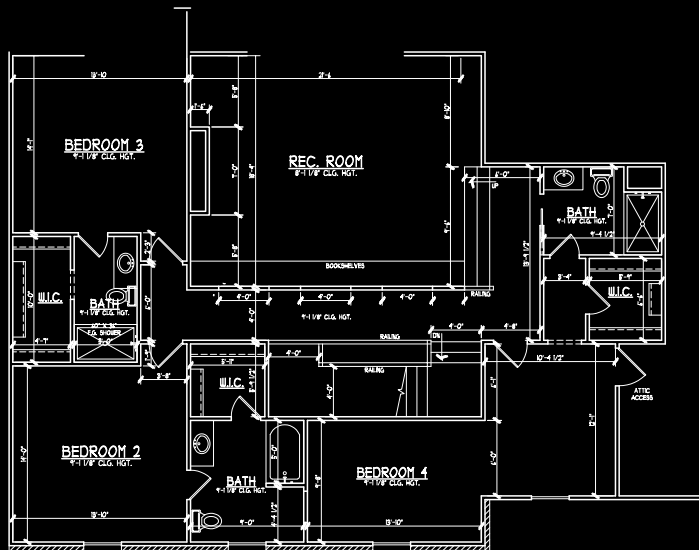
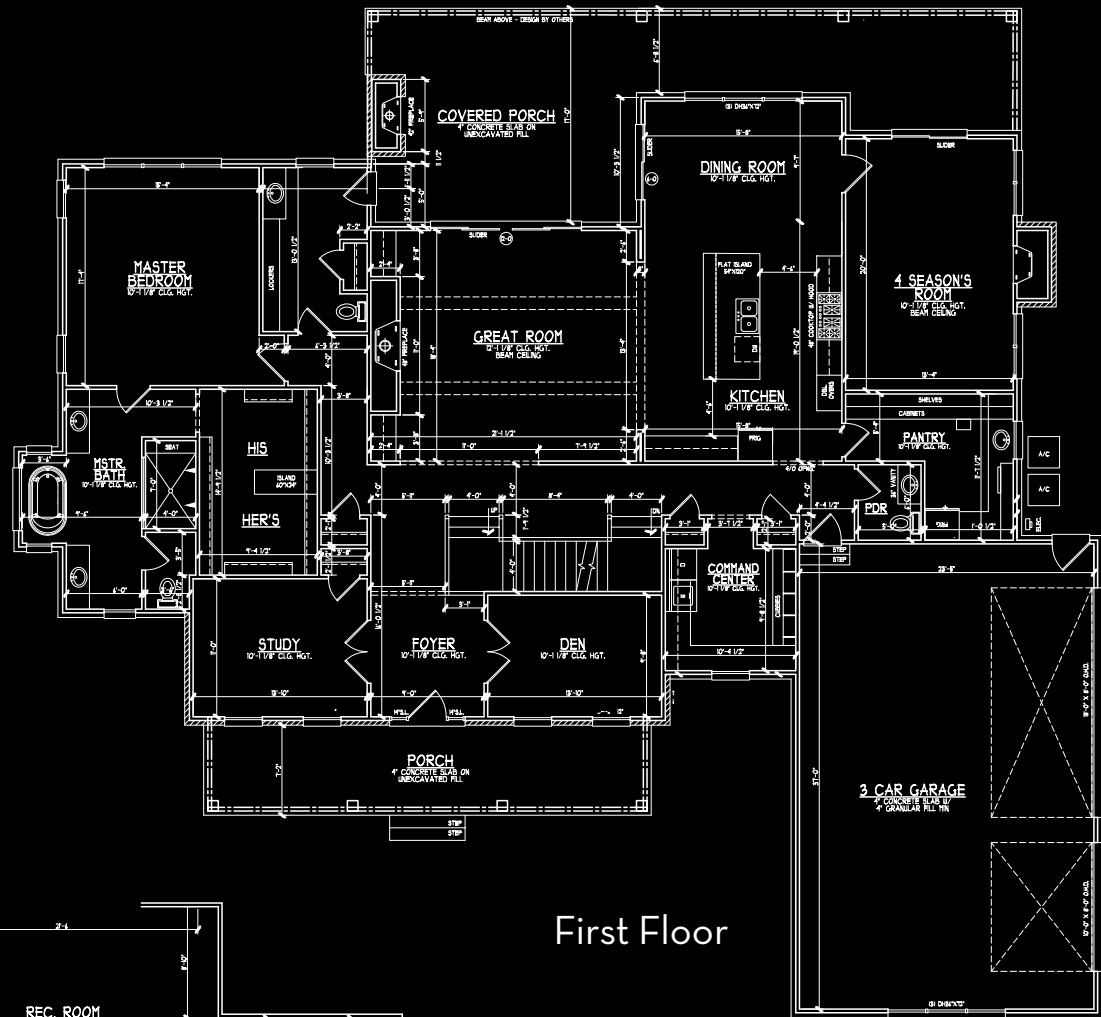

## Square Footage

First Floor	3,040 Sq. Ft.
Garage	893 Sq. Ft.
Covered Porch	608 Sq. Ft.
Front Porch	276 Sq. Ft.
Second Floor	1,755 Sq. Ft.
<b>Total Finished</b>	<b>6,931 Sq. Ft.</b>
<b>Total Sq. Ft.</b>	<b>7,732 Sq. Ft.</b>

## Second Floor



Westfield, Indiana 46074  
317.432.7364

[gollnerhomes.com](http://gollnerhomes.com)

